

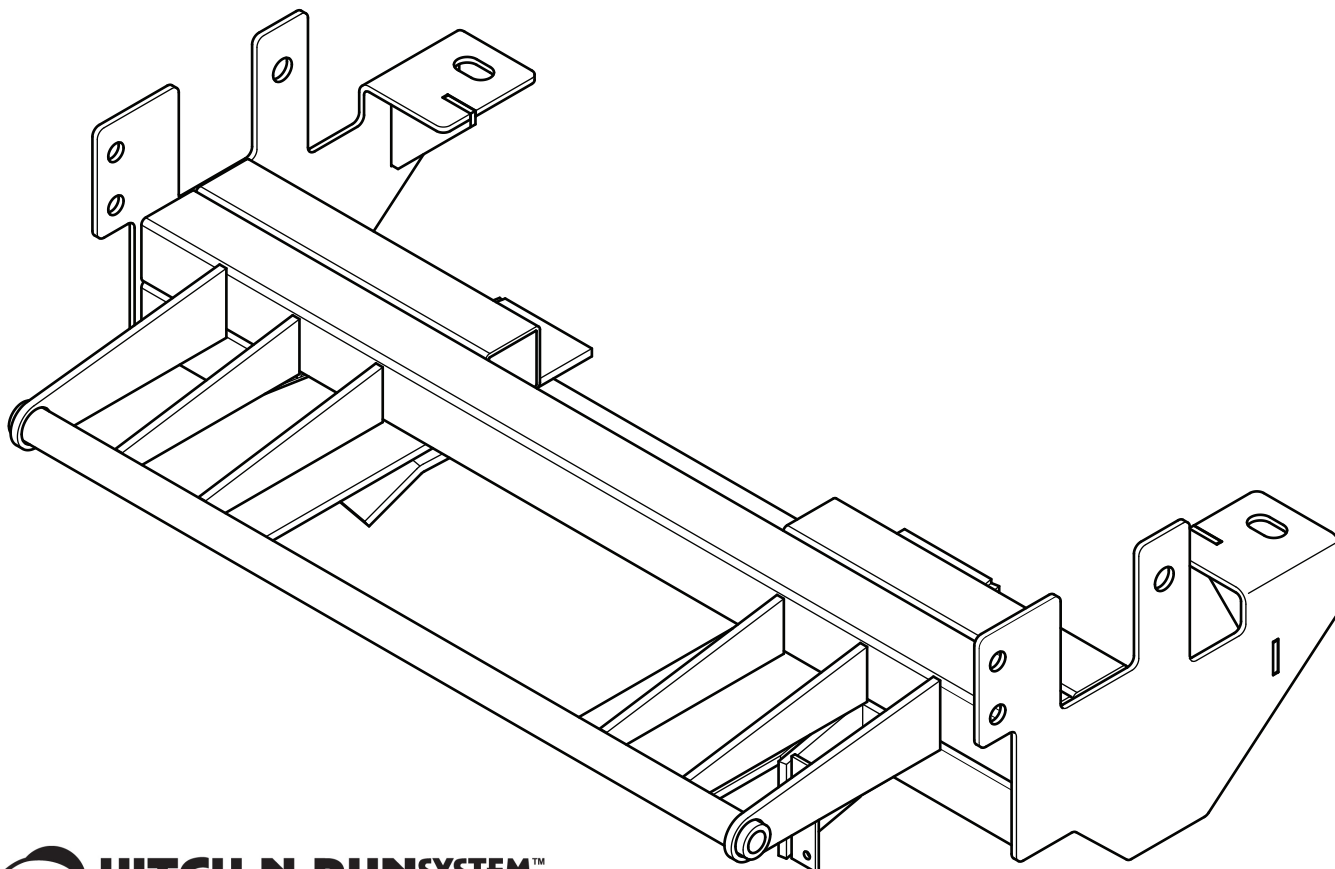

HOME-PRO[®] 3000

2008 - 2012 GM Colorado 4 x 4
2008 - 2012 GM Canyon 4 x 4
With Max. GVWR & Max. FGAWR ONLY

Vehicle Mounting Kit: 1FK48



September 10th, 2012

Curtis Industries Inc. LLC, 111 Higgins St., Worcester, MA 01606 TEL: (800) 343-7676 FAX: (508) 854-3377 For Parts and information visit us at www.Curtisindustries.net
Curtis Industries Inc. LLC, reserves the right to change product design or specifications without notice or liability.
Curtis Snow Plows are protected by the following U.S. Patent Numbers: 6,145,222 and 6,209,231 Licensed under U.S. Patent Number 5,568,694 & Canadian Patent Number 2,137,853.
Other patents pending.

1FK48 Vehicle Mount Kit Parts List

Item #	Description	Qty.
1	Mounting Frame	1
Hardware Bag Components Included In This Kit		
2	12mm x 1.75 x 110 mm Bolts	4
3	12mm x 1.75 Nuts	4
4	12mm Lock Washers	4
5	12mm Flat Washers	4
6	5/8-11 x 4-1/2" Bolts	2
7	5/8" Flat Washers	6
8	5/8" Lock Washers	4
9	5/8-11 Nuts	4
10	5/8-11 x 1-1/2" Strap Bolts - 12" Long	2
Hardware Components Included In Plow Kit		
1a	Dual Plug Harness Bracket	1
-	10-32 x 3/4" Hex Head Screw, Plated	2
-	10-32 Nylock Lock Nut, Plated	2
-	8-32 x 1" Hex Head Screw, Plated	1
-	8-32 Nylock Lock Nut, Plated	1
-	#8 Nylon Flat Washer, 3/4" O.D.	1
-	#8 Flat Washer, SAE, Plated	1



WARNING

It is highly recommended that front "helper springs", "airshocks", or other similar devices be installed onto this vehicle to prevent the front suspension from "bottoming out" while carrying a snow plow.

Vehicle must be properly "ballasted" by placing ballast weight behind the centerline of Rear Axle so that no more than 62% of the total weight of the Vehicle, Snow Plow, Driver, Ballast weight, (and any cargo) is placed on the Front Axle while at the same time not exceeding the Gross Vehicle Weight Rating and Front or Rear Gross Axle Weight Ratings.

1FK48 Mounting

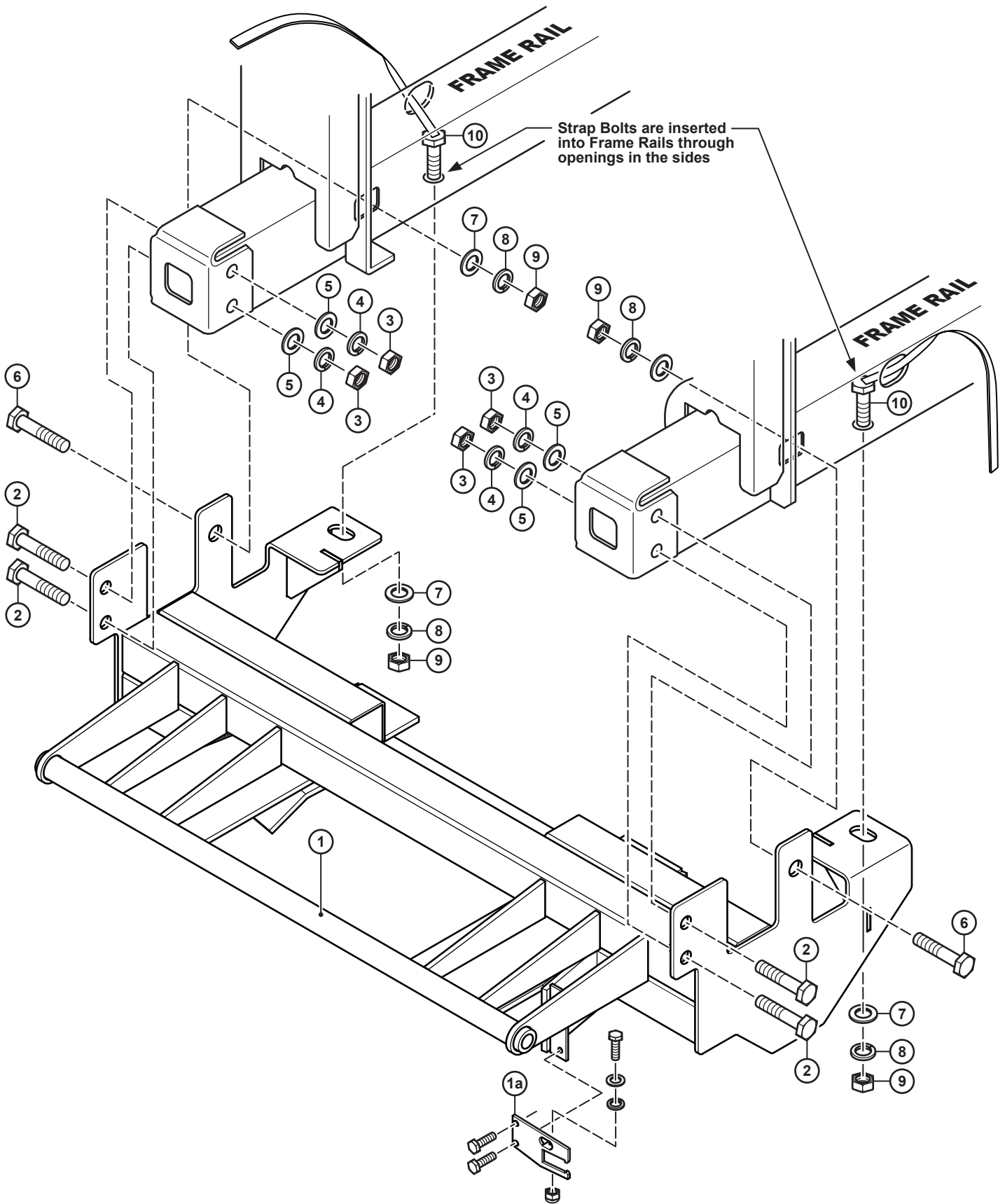

Curtis Industries, LLC. reserves the right to change product design or specifications without notice or liability. Curtis Snow Plows and Truck equipment should only be used on vehicles equipped with the manufacturer's Snow Plow preparation package. Snow Plowing without the original snow plow preparation package may damage your vehicle and the added weight of the equipment may impair the operation and control of the vehicle.

1FK48: 2008 - 2012 GMC Canyon/Colorado

Mounting Kit Installation Instructions

1. VEHICLE PREPARATION

- (1a.) Remove the plastic grill by detaching the four upper plastic clips by pushing down on the center tab. Then pull gently on the grille until the lower push clips release.
- (1b.) Remove the front bumper by removing the two cap screws from each side bracket and the four cap screws (two on each side) from beneath the grille. See Figure 1. Retain the fasteners for reinstallation of the bumper. Fog lights may need to be disconnected for bumper removal. Remove the Lower Bumper Valance.
- (1c.) If the vehicle is equipped with tow hooks, remove both tow hooks and bolts.

Figure 1. Front Bumper Bolt Locations Under Hood

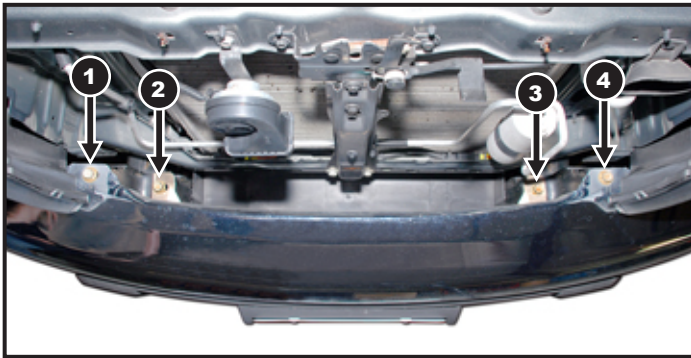

- (1d.) Remove the vehicle Skid / Splash Plate and cut away the section of the Skid / Splash Plate indicated in Figure 5, or set aside the Skid / Splash Plate. The Skid / Splash Plate can be left off of the vehicle if desired.

IMPORTANT

If the plow mounting frame (1) is ever removed from the vehicle, the original equipment skid / splash pan must be reinstalled before the vehicle is put back into service.

- (1e.) Trim away the center section of Lower Bumper Valance as shown in Figure 6.
- (1f.) Trim away the center section of the Bumper Valance shown in Figure 7.

2. MOUNTING FRAME

- (2a.) Lift the mounting frame (1) up under the front of the vehicle and align the holes in the front of the mount with the existing holes at the front of the frame at the tow hooks. If the vehicle was equipped with tow hooks., reinstall the tow hooks with M12 x 110mm Bolts (2), 12mm Flat Washers (5), 12mm Lock Washers (4) and 12mm x 1.75 Nuts (3), by inserting the fasteners through the tow hook and mount, then into frame.



NOTE

All fasteners should remain loose or "finger tight" until all components have been attached to Vehicle or installation instructions specify tightening.

If the vehicle was not equipped with tow hooks, the hardware will be installed in the same sequence. Refer to Mounting Diagram.

- (2b.) Using the large access hole in the side of the vehicle frame behind the mount, install the 5/8-11 Strap Bolts (10) with the handles out through the existing hole in the frame and the rear hole of the mount. Place a 5/8" Flat Washer (7), a 5/8" Lock Washer (8), and a 5/8-11 Nut (9) on each Bolt. Hand tighten the hardware.

Figure 2. Strap Bolt - Driver's Side shown

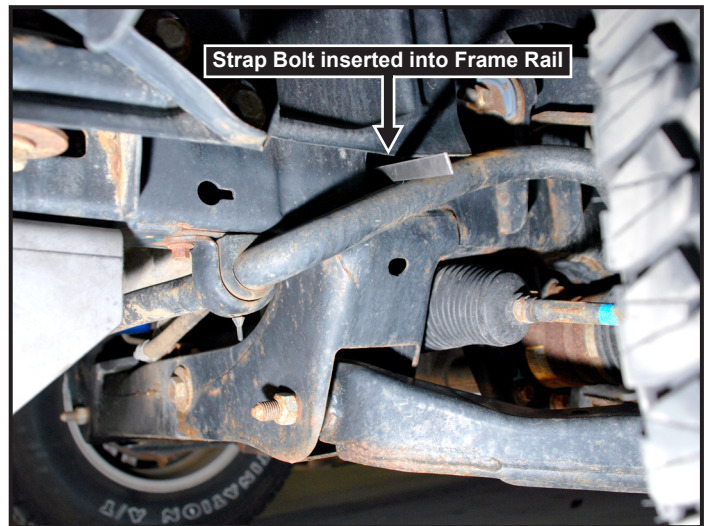

- (2c.) Hold the mount tight to the bottom of the frame using a floor jack. Tighten all installed mounting frame, bumper bracket, and tow hook fasteners at this time.

3. FINAL ADJUSTMENT AND INSPECTION

Inspect the mounting attachment and original equipment bolts to be certain that they are all in place and that they are all tight.

Figure 3. Firewall Drilling Location Under Hood

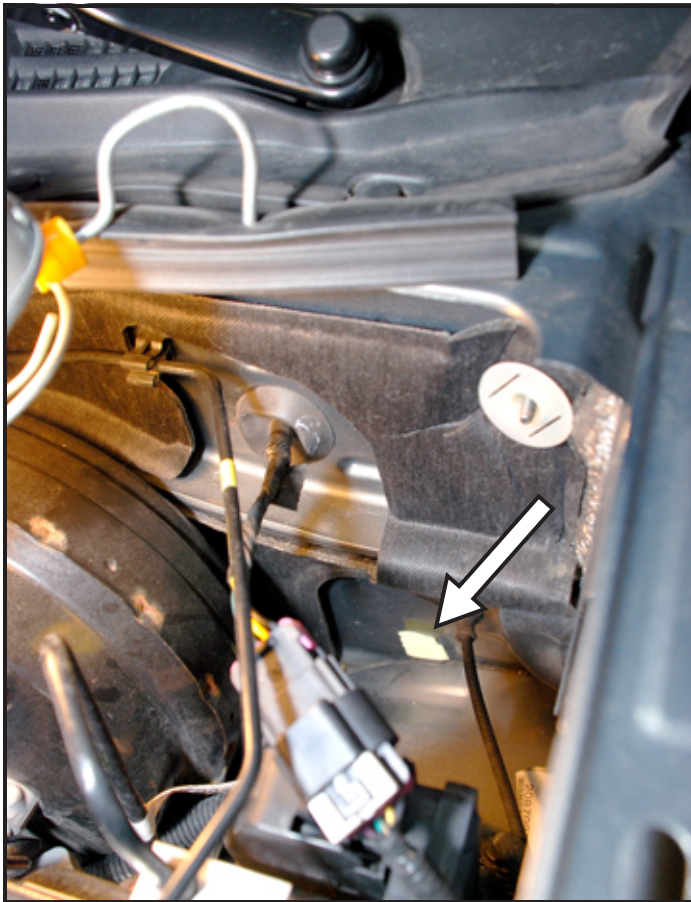

Figure 4. Firewall Drilling Location In Cab

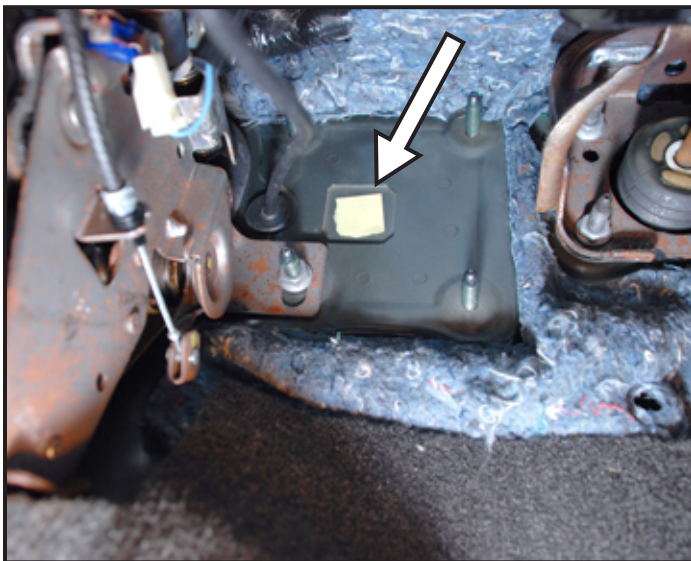

Figure 5. Skid / Splash Plate Trim

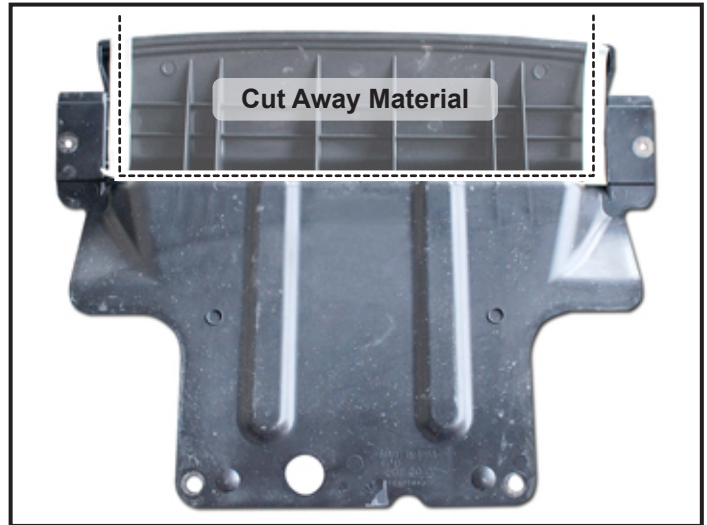

Figure 6. Lower Bumper Valance Trim

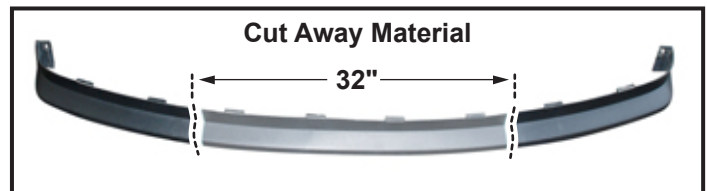
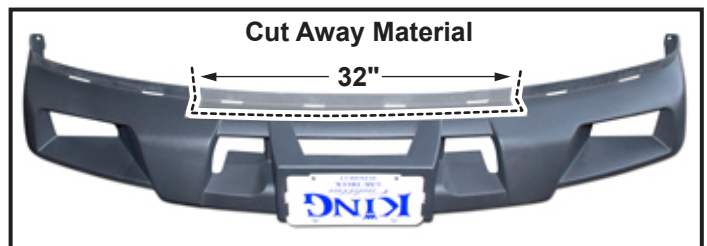

Figure 7. Bumper Valance Trim



4. OPTIONAL PLUG MOUNT BRACKET INSTALL



NOTE

Install the Plug Mount Bracket if the harness will be mounted on the frame kit, otherwise, the harness may be routed through the grill, bumper, etc.

Using (2) 10-32 x 3/4" hex bolts and nylon locknuts, fasten the Plug Mount Bracket to the Plug Mount Bracket Mounting Tab located on the drivers side of the frame kit receiver. The included 8-32 hardware is used for mounting the hi-amp battery leads to the Plug Mount Bracket, if used.

